

# TDS TECHNICAL DATA SHEET

## DAINTY JUNIOR

Surface Mirror Optics CFL Luminaire



### Description:

**DAINTY JUNIOR** is an Indoor surface mounted luminaire with high efficiency mirror optics with parabolic side reflectors and matt finished cross louvers for limited glare control and suitable for twin 18 W CFL Lamps.

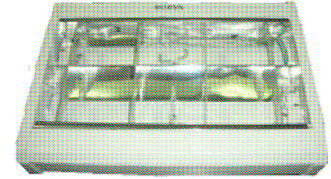

### Technical Specification:

**Housing :** Pre-treated CRCA MS with epoxy powder coated finish.

**Side Reflector :** Aluminium anodized high bright parabolic reflector for good optical performance.

**Cross Louver:** Anodized aluminium, matt finish to limit degree of glare.

**Internal Wiring:** PVC insulated. Single strand copper conductor.

**Mains Terminal:** 10 amps. suitable for terminating 2.5 sq.mm conductor.

**Hardware:** MS; Zinc plated & passivated.

**Earthing:** 1 No. inside, suitable for 2.5 sq. mm. earthing conductor.

**Ballast:** Option available for both Electro Magnetic Ballast (EMB) & Electronic Ballast (EB).

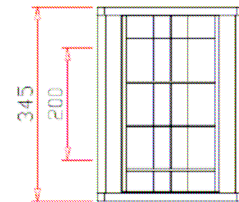
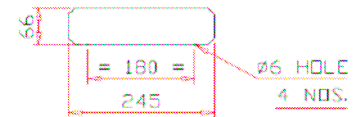

Nominal Dimensions in mm, Tolerance +/- 2 mm

### Range:

CAT.REF:	Lamp	Voltage	Ballast	Capacitor	Mains current	Power factor	Approx Wt (Kg)
SCS 211 CF	2X11 CFL	240V	EMB	NA	0.30 A	>0.85	1.50
SCS 211 CF EB1/P3	2X11 CFL	240V	EB	NA	0.13 A	>0.95	1.10
SCS 218 CF-D	2X18 CFL	240V	EMB	4 MFD	0.44 A	>0.85	1.6
SCS 218 CF-D EB1/P3	2X18 CFL	240V	EB	NA	0.16 A	>0.95	1.21
SCS 218 CF-L	2X18 CFL	240V	EMB	4 MFD	0.44 A	>0.85	1.6

### Installation:

Four nos. clear embossed holes for chain suspension.

### Application:

Retail shop, Software parks, Offices, Banks  
Conference rooms, Offices of Financial Services, etc.



DRAWN	PB	DRG.NO :	TD 02-008
CHECKED	SN	REV. NO:	0
APPROVED	SC	DATE:	20.02.2009

Luminaire Business Group

Surya Roshni Ltd, Padma Tower-I, Rajendra Place, New Delhi-110008

As improvement in design & method of manufacturing is a continuous process, the product supplied may differ in detail from given here.